

# Day/Night Camera

S-MIR8322HQDN-M, S-MIR8362HQDN-M

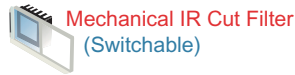

## S-MIR8322HQDN-M Features

- 1/3" SONY Exview HAD CCD
- SONY HQ1 / 540TVL / 0.05 Lux@F1.0
- AES/AGC/BLC/Digital Day&Night (ON/OFF)
- Mechanical IR Cut Filter
- Line Lock\ 8 Steps Manual Shutter
- Video/DC IRIS Control

S-MIR8322HQDN-M



S-MIR8362HQDN-M



## S-MIR8362HQDN-M Features

- 1/3" SONY Super HAD CCD
- SONY HQ1 / 540TV / 0.15Lux@F1.0
- AES/AGC/BLC/Digital Day&Night (ON/OFF)
- Mechanical IR Cut Filter
- Line Lock\ 8 Steps Manual Shutter
- Video/DC IRIS Control

## Specifications

	S-MIR8322HQDN-M		S-MIR8362HQDN-M	
	PAL	NTSC	PAL	NTSC
TV System	PAL	NTSC	PAL	NTSC
Image Sensor	1/3" SONY Exview™HAD CCD		1/3" SONY SUPER HAD CCD	
Number of Total Pixels	795(H)x596(V)	811(H)x508(V)	795(H)x596(V)	811(H)x508(V)
Resolution ; DSP	540TVL ; SONY HQ1			
Minimum Illumination	0.05Lux@F1.0		0.15Lux@F1.0	
Video Output ; Connector	1.0Vp-p Composite, 75 Ω ; BNC			
Signal to Noise Ratio	More than 50dB (SUPER AGC off)			
Gamma Correction	0.45			
Mechanical IR Cut Filter	Automatically Switches (B&W Mode<2Lux, Color Mode>8Lux)			
IR LED ; Working Distance	Available with Infrared Illuminator			
Synchronizing System	INTERNAL / LINE LOCK (AC Version Only)			
Automatic Electronic Shutter	AES:1/50(60)sec.~1/100,000sec. 0.1/50(60)sec. 1/120(100)sec. 2/125(50)sec. 3/150(50)sec. 4/1/1000sec. 5/1200(50)sec. 6/1400(50)sec. 7/1/10000sec.			
Automatic Gain Control	AGC / SUPER AGC			
Automatic White Balance	Automatic			
Back Light Compensation	ON / OFF			
Flickerless	NA			
DNR ; Sense Up	NA			
Digital Day&Night Mode	COLOR (Day:Color, Night:Color) / D&N (Day:Color, Night:B/W)			
Automatic IRIS ; Connector	VIDEO / DC ; D4 IRIS Jack			
Adjustment VR	DC Level, L.L V-phase			
Lens Mount	C / CS mount (With Adaptor)			
Lens, Angle of View(H)	Lens Option: Please See the Page of Lens Series			
Power Supply ; Consumption	12Vdc/24Vac:3.5W, 90~260Vac:4.5W			
Operation ; Storage Temp.	-10°C~50 °C ; -20°C~60 °C			
Operation ; Storage Humidity	Maximum:RH80% ; RH90%			
Dimensions	60(W)x50(H)x120(D)mm			
Net Weight	12Vdc/24Vac:250g, 90~260Vac:300g			
Accessories Series Option(Page)	Lens:SHV-IR2812DAI, SHV-IR3085DAI(G-5), SHV-IR7550DAI(G-6) Bracket:MTB-101, MTB-102(G-3) ; Housing(G-4)			

specifications and appearance are subject to change without notice

## Dimensions

UNT:mm Tol:±0.5

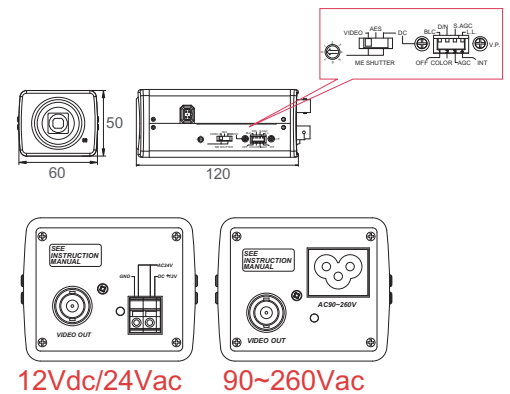

12Vdc/24Vac

90~260Vac