

# Day/Night High Res. Hi-Sensitive Rugged Dome Camera

1/3" Color/Mono, Exview, 480 TVL, 2x D/N Vari-Focal, 0.4lux

HR-D01PH-GK



## Features

- SONY SS-1M digital signal processor (DSP) allows better picture quality and full function control
- 1/3" SONY Exview HAD CCD with 470K/410K pixels (PAL/NTSC)
- High resolution 480 TV Lines
- Accept IR lamp or LED illuminator
- High sensitivity less than 0.4 lux at F1.6 (30 IRE, SAGC on); 0 lux under infrared illumination
- Color/Mono auto switching
- Outstanding signal to noise ratio better than 48dB
- 225 areas auto detects back light compensation
- Heavy-duty, Weather proof & vandal proof with IP66 protection
- Automatic Internal/Line Lock switching function
- Isolated switching power 12V DC/24V AC

## Specifications

MODEL NO.	KR-4HVA2P-R	KR-4HVA2N-R
Image sensor	1/3" Interline Transfer SONY Exview HAD CCD	
Signal system	PAL	NTSC
Picture elements	795 (H) x 596 (V)	811 (H) x 508 (V)
Scanning system	625 lines, 2:1 Interlace	525 lines, 2:1 Interlace
Sync system	DC Internal lock/ AC Line-lock	
Horizontal resolution	480 TVL	
Minimum illumination	0.4 lux at F1.6 (30 IRE, SAGC ON)	
	0 lux under infrared illumination	
Day/Night change level adj.	0.1 ~ 9 Lux	
Day/Night change delay time	6 ~ 60 sec	
S / N ratio	Better than 48dB	
Auto Iris Mode	1/50 sec	1/60 sec
Auto Iris lens type	3.5~8mm F1.6 D/N DC Drive Iris lens	
	9~22mm F2.0 D/N DC Drive Iris lens optional	
White balance	ATW 2500°K ~ 9500°K	
Backlight compensation	Auto Detect ON/OFF; Histogram plus 225 area windows weight	
Video output signal	BNC, 1.0V p-p at 75Ω load	
Operation temperature	-10°C to 50°C	
Power source	DC 12V/ AC 24V switching	
Power consumption	3.5W	
Dimensions (D x H)	149 x 102 mm	

specifications and appearance are subject to change without notice

## Dimensions

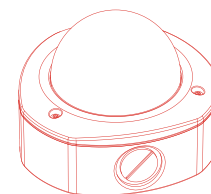
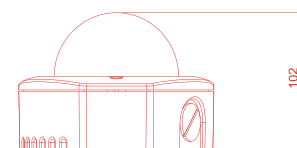
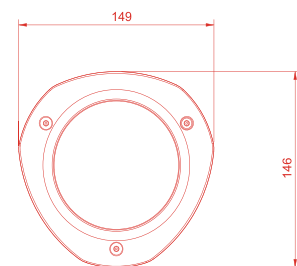

### Lens Options

KR-4HVA2P

- A: 3.5~8mm F1.6 D/N
- B: 9~22mm F2.0 D/N